

66/5

**RINVII AD ANGOLO
GEARBOX
WINKELGETRIEBE**



• Sono realizzati nei rapporti di riduzione: 1:1 - 1:2 in riduzione (standard) - 2:1 in moltiplica (a richiesta sulle versioni A-B-C, non disponibile nella versione D). (Fig. 5-6)

• Corpo in alluminio, anodizzato; alberi in acciaio inox AISI 303

• Momento torcente **12 Nm**

• Carico radiale **25 kg** - carico assiale **2,5 kg** (Fig. 7)

• Modelli:

Versione A con 2 uscite

Versione B con 3 uscite o **Versione C** (rotazione contraria) con 3 uscite

Versione D con 3 uscite, 2 ad albero cavo

Versione E con 4 uscite

• 2 uscite peso gr. 300; 3 uscite peso gr. 400

• Alberi di uscita: **M** = maschio / **F** = femmina **Ø10** (vedi "Versioni con dimensioni di ingombro" da pag. 33)

➤ **Disponibili a richiesta:**

• Alberi di uscita: maschio **Ø14** / femmina **Ø12 - Ø14**

• Versione con corpo in inox AISI 303.

• Available with reduction ratios: 1:1 - 1:2 in reducing (standard) - 2:1 in multiplying (on request available in version A-B-C, not available in version D). (Fig. 5-6)

• Aluminium case, anodised, stainless steel shafts AISI 303

• Torque **12 Nm**

• Radial load **25 kg** - axial load **2,5 kg** (Fig. 7)

• Models:

Version A with 2 outputs

Version B with 3 outputs or **Version C** (opposite rotation) with 3 outputs

Version D with 3 outputs, 2 through hollow shafts

Version E with 4 outputs

• 2 outputs, weight 300g.; 3 outputs, weight 400g.

• Output shafts: **M** = male / **F** = female **Ø10** (see "Versions with dimension drawings" from pg. 33)

➤ **Available on request:**

• Output shafts: male **Ø14** / female **Ø12 - Ø14**

• Version with case in stainless steel AISI 303

• Es sind verschiedenen Untersetzungen lieferbar 1:1 - 1:2 in Reduktion (Standard) - 2:1 multipliziert (auf Anfrage in Version A-B-C, nicht lieferbar in Version D). (Fig. 5-6)

• Druckgussgehäuse, eloxiert; Wellen aus Edelstahl (Standard).

• Drehmoment **12 Nm**

• Radiallast **25 kg** - Axiallast **2,5 kg**. (Fig. 7)

• Ausführungen:

Version A mit 2 Ausgangswellen

Version B mit 3 Ausgangswellen oder **Version C** (Rückwärtsdrehung) mit 3 Ausgangswellen

Version D mit 3 Ausgangswellen, 2 Hohwellen

Version E mit 4 Ausgangswellen

• 2 Ausgänge, Gewicht gr. 300; 3 Ausgänge, Gewicht gr. 400

• Standard-Ausgangswellen: Standard **M** = Vollwellen / **F** = Hohl-Wellen **Ø10** (siehe "Ausführungen mit Abmessung" ab S. 33)

➤ **Lieferbar auf Anfrage:**

• Vollwellen **Ø14** / Hohlwellen **Ø12 - Ø14**

• Ausführung mit Gehäuse in Edelstahl AISI 303

ESEMPIO DI ORDINAZIONE - PART NR. CONFIGURATION - BESTELLMUSTER:

66/5

INOX

A

M-F

1:1

OPZIONALE - OPTIONAL - OPZIONAL

ACCIAIO INOSSIDABILE - STAINLESS STEEL - EDELSTAHL

INOX

VERSIONE - VERSION - VERSION (vedi p. 33)

A - B - C - D - E

ALBERI - SHAFTS - WELLEN (vedi p. 33)

M - F - F **Ø10** (standard); **Ø12 - Ø14** (opzionali - optional - opzional)

RAPPORTI - RATIOS - ÜBERSETZUNGEN:

1/1 - 1/2 - 2/1

- Per la scelta del rinvio, consigliamo di consultare le figure, le tabelle e i dati tecnici riportati nelle "Informazioni generali" di questo catalogo (pag. 16 - 18).

- To choose the most suitable gearbox, we advise to consult the figures, tables, and the technical data shown in the "General Information" of this catalog (p.16 - 18).

- Für eine korrekte Auswahl, empfehlen wir die Figuren, die Tabellen und die Daten, in den "Allgemeine Informationen" dieses Katalogs (S. 16 - 18) nachzuschlagen.

RAFFIGURAZIONE DEI RAPPORTI DI RIDUZIONE E MOLTIPLICA - REPRESENTATION OF REDUCTION AND MULTIPLYING RATIOS - DARSTELLUNG VON UNTERSETZUNG UND ÜBERSETZUNG

Fig. 5

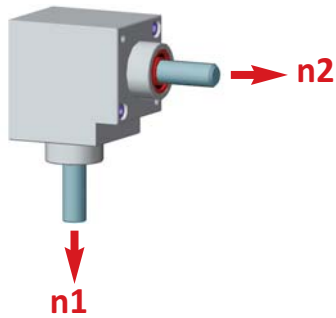
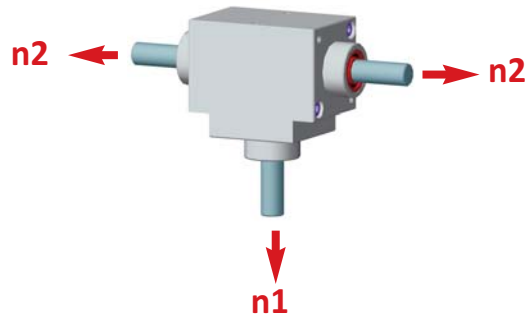

Fig. 6



Esempio - Example - Beispiel

1:2 in riduzione - reduction - ins Langsame:
n1 = 1000 RPM
n2 = 500 RPM

* 2:1 in moltiplica - multiplication - ins Schnelle:
n1 = 1000 RPM
n2 = 2000 RPM

* a richiesta disponibile nella versione A-B-C;
 non disponibile nella versione D.
 on request available in version A-B-C,
 not available in version D.
 auf Anfrage in Version A-B-C, nicht lieferbar
 in Version D.

RAFFIGURAZIONE DEI CARICHI E INGRANAGGI - REPRESENTATION OF LOADS AND BEVEL GEARS - DARSTELLUNG VON LASTEN UND KEGELRÄDER

Fig. 7

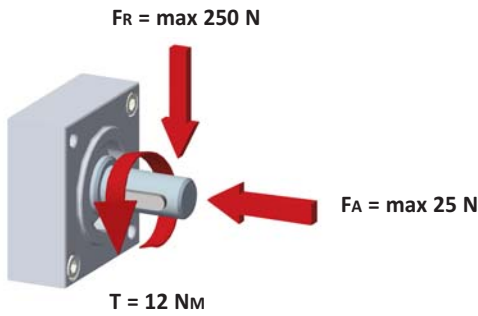
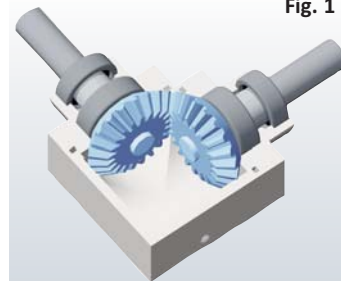
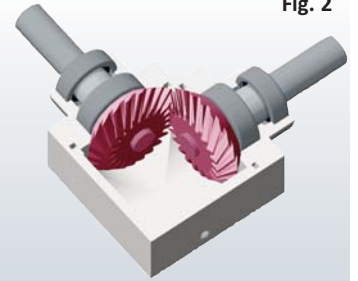

Fig. 1



Ingranaggi conici dritti
 Straight bevel gears
 Gerade Kegelräder

Fig. 2



Ingranaggi conici spiriodiali
 Spiral bevel gears
 Spiralkegelräder

ALCUNE APPLICAZIONI - SOME APPLICATION - EINIGE ANWENDUNGEN



COPIA IN USCITA CON RAPPORTO 1/1 - **OUTPUT TORQUE WITH RATIO 1/1** - **DREHMOMENT MIT ÜBERSETZUNG 1/1**

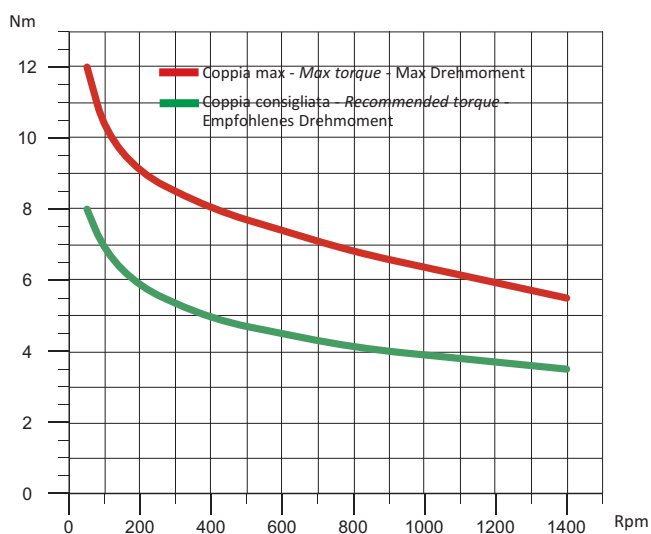

T _M dc	12	10,2	9	8	6,8	5,5
T _R dc	8	6,8	5,8	4,9	4,1	3,5
rpm	50	100	200	400	800	1400

Rendimento - Efficiency - Leistung = 90%

COPIA IN USCITA CON RAPPORTO 1/2 - **OUTPUT TORQUE WITH RATIO 1/2** - **DREHMOMENT MIT ÜBERSETZUNG 1/2**

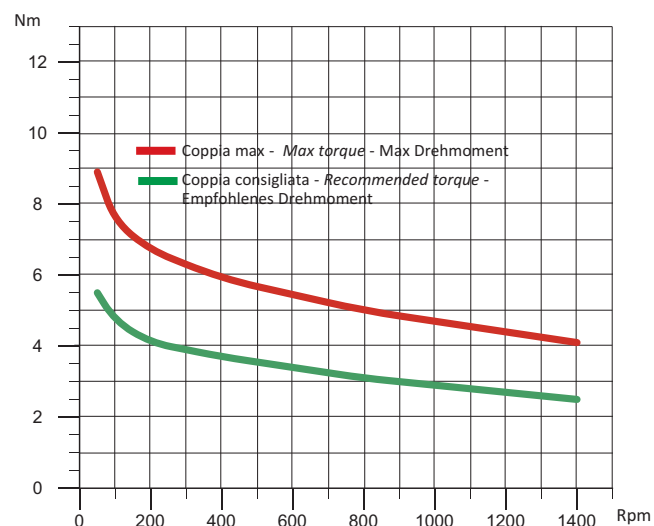

T _M dc	8,9	7,5	6,7	5,9	5	4,1
T _R dc	5,5	4,7	4,1	3,7	3,1	2,5
rpm	50	100	200	400	800	1400

Rendimento - Efficiency - Leistung = 90%

COPIA IN USCITA CON RAPPORTO 2/1 - **OUTPUT TORQUE WITH RATIO 2/1** - **DREHMOMENT MIT ÜBERSETZUNG 2/1**

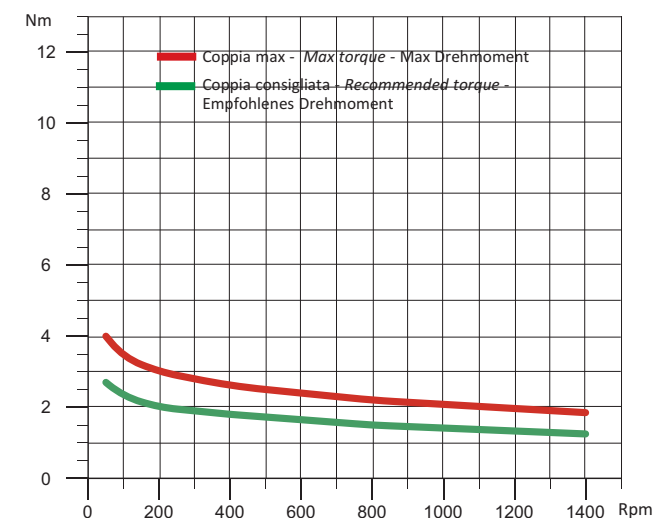

T _M dc	4	3,4	3	2,6	2,2	1,85
T _R dc	2,7	2,3	2	1,8	1,5	1,25
rpm	50	100	200	400	800	1400

Rendimento - Efficiency - Leistung = 90%

- Per abbreviazioni e sigle consultare il «glossario» nelle «Informazioni generali» di questo catalogo (pag. 18).

- For abbreviations and acronyms consult the «glossary» in the «General Information» of this catalog (p. 18).

- Für Abkürzungen und Akronyme den «Glossar» konsultieren in den «Allgemeine Informationen» dieses Katalogs (S. 18).

ALBERI DI USCITA DISPONIBILI - AVAILABLE OUTPUT SHAFTS - LIEFERBARE AUSGANGSWELLEN

M = maschio - male - Vollwelle

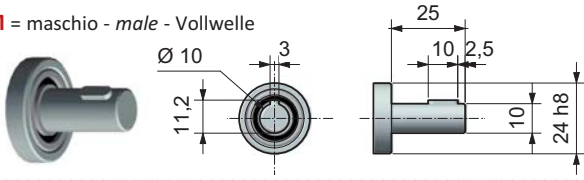

F = femmina - female - Hohlwelle

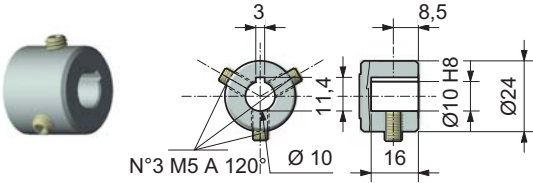

F = femmina passante - through-female - durchgehende Hohlwelle (solo per la versione "D" - only for version "D" - nur für Version "D")

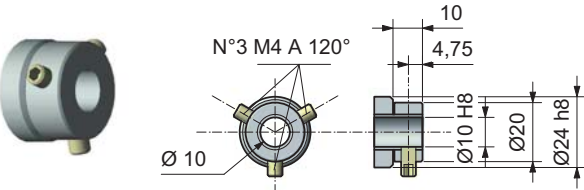

VERSIONE - VERSION "A" M-M

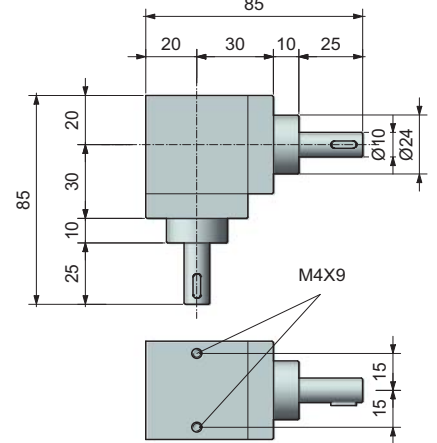
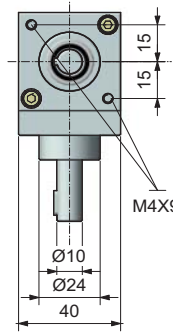
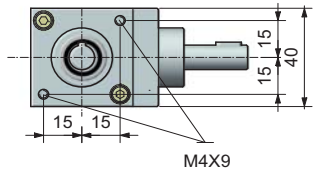

VERSIONE - VERSION "A" F-F

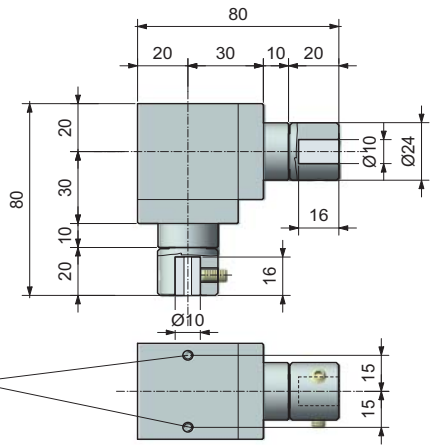
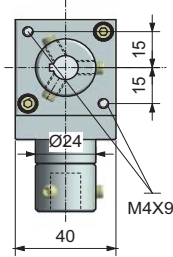
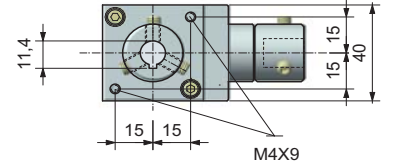

VERSIONE - VERSION "A" M-F

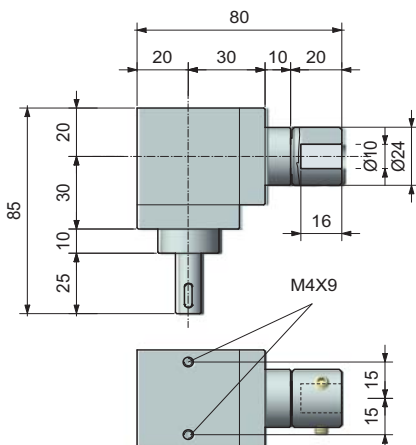
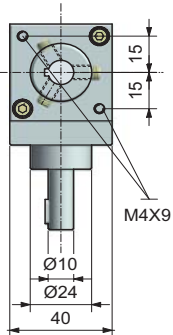
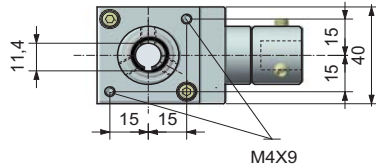

VERSIONE - VERSION "B" M-M-M

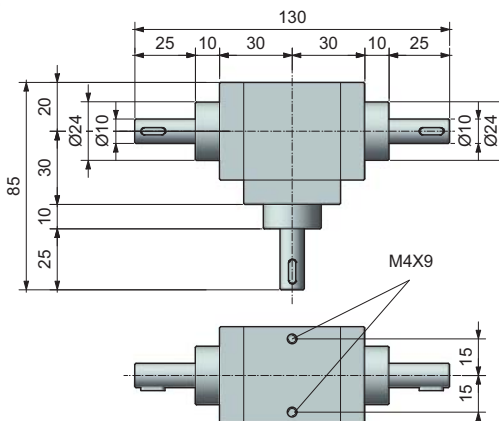
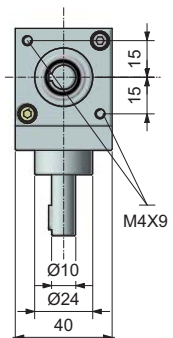
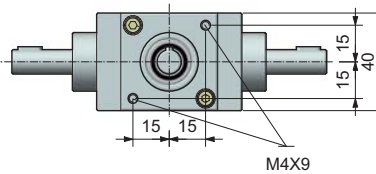

VERSIONE - VERSION "B" F-M-M

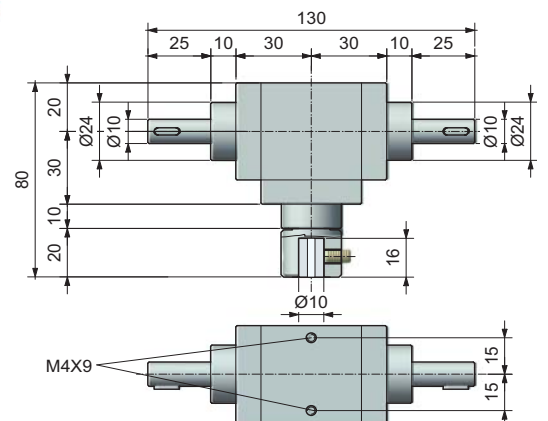
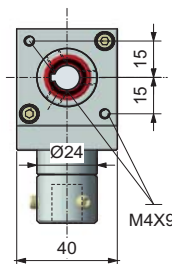
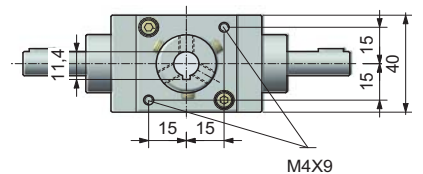
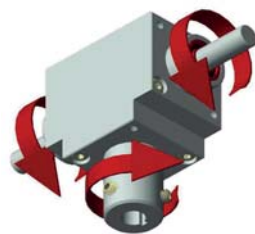

VERSIONE - VERSION "C" M-M-M

ROTAZIONE OPPOSTA
OPPOSITE ROTATION
RÜCKWÄRTSDREHUNG

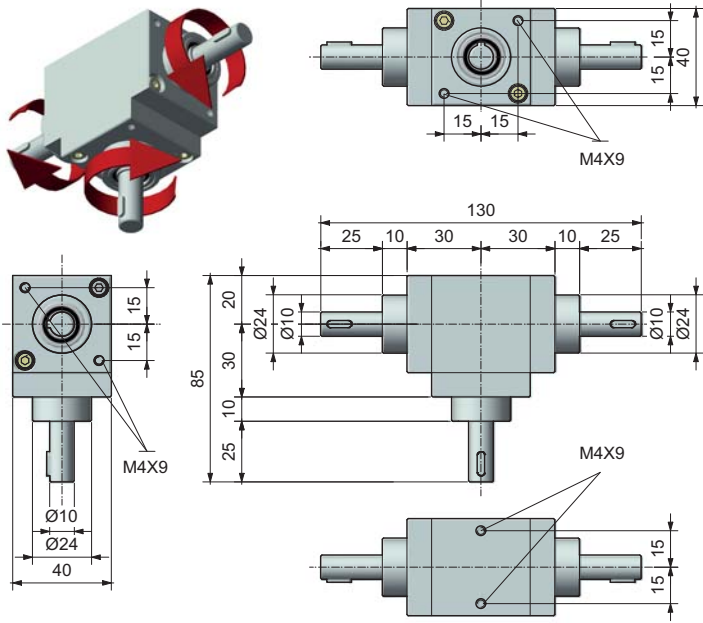

VERSIONE - VERSION "C" M-F-F

ROTAZIONE OPPOSTA
OPPOSITE ROTATION
RÜCKWÄRTSDREHUNG

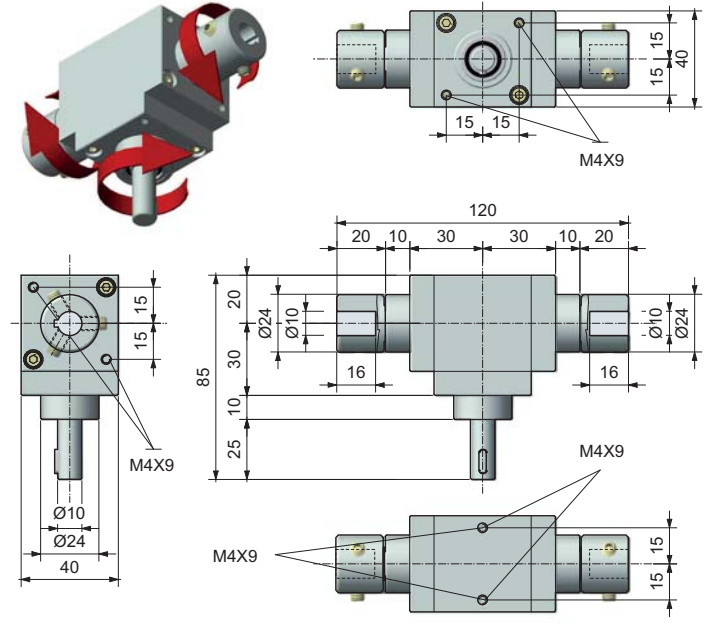

VERSIONE - VERSION "C" F-M-M

ROTAZIONE OPPOSTA
OPPOSITE ROTATION
RÜCKWÄRTSDREHUNG

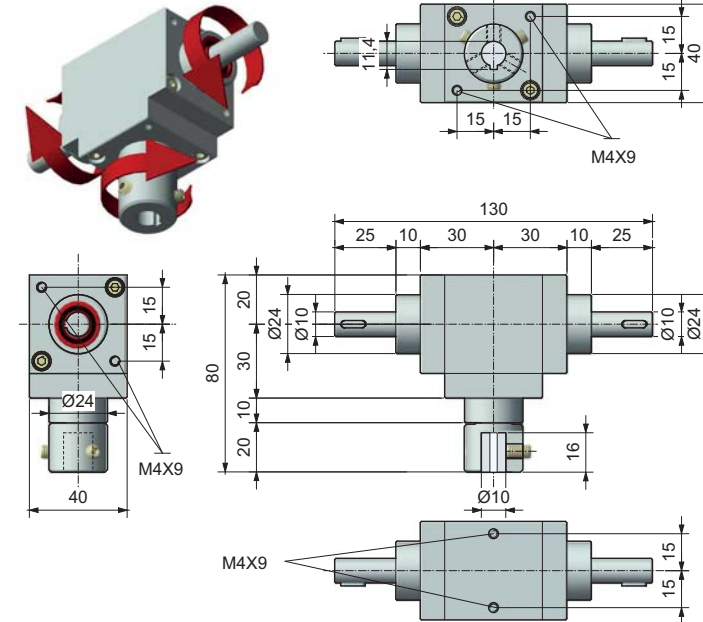

VERSIONE - VERSION "C" F-F-F

ROTAZIONE OPPOSTA
OPPOSITE ROTATION
RÜCKWÄRTSDREHUNG

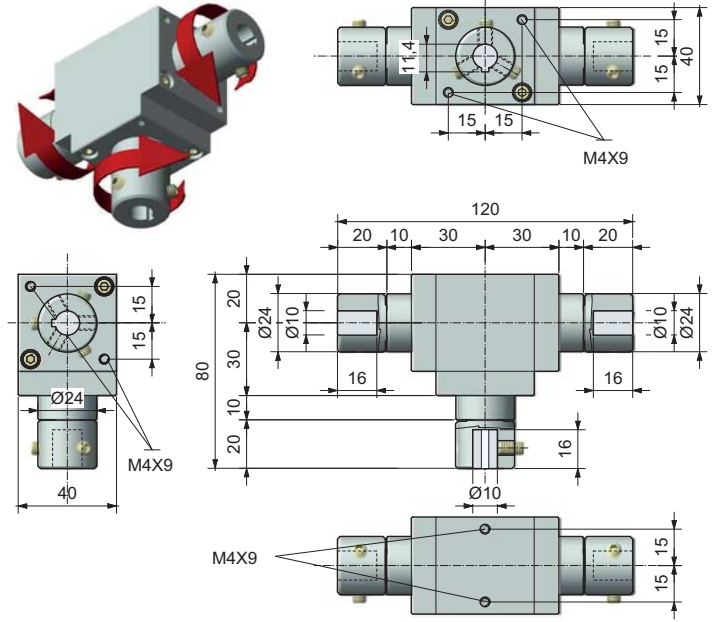

VERSIONE - VERSION "D" M-M-M

CON ALBERO PASSANTE
WITH THROUGH-HOLLOW SHAFT
MIT DURCHGEHENDER HOHLWELLE

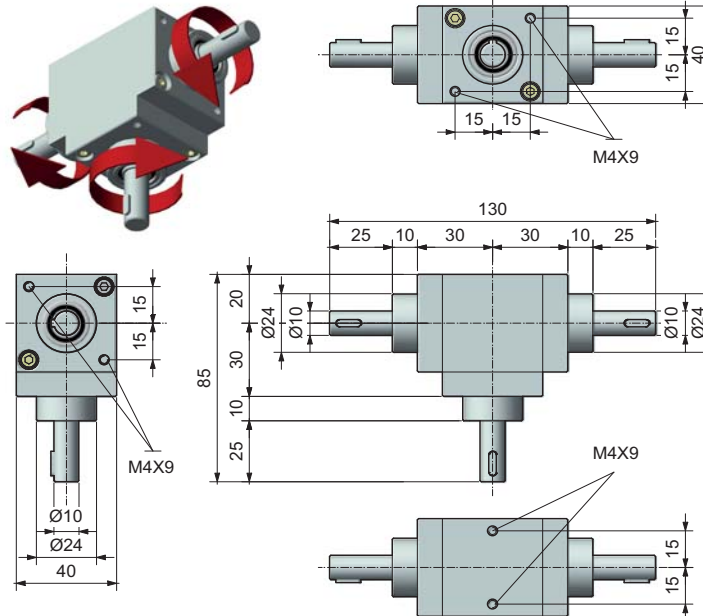

VERSIONE - VERSION "D" F-F-F

CON ALBERO PASSANTE
WITH THROUGH-HOLLOW SHAFT
MIT DURCHGEHENDER HOHLWELLE

